



**METAL<sup>®</sup>**  
**WORK**  
P N E U M A T I C



C A T A L O G N P T  
P U S H - I N F I T T I N G S





**FOREIGN SUBSIDIARIES**

**EUROPE**

 **AUSTRIA**  
Metal Work Pneumatic GmbH  
Josef - Wilberger - Strasse 1  
A - 6020 Innsbruck - Austria  
Tel. 0043 512 26 22 61  
Fax 0043 512 26 22 62  
metalwork@metalwork.at

 **BELGIUM**  
Metal Work België/Belgique  
Mechelse Steenweg 277  
B-1800 Vilvoorde - Belgium  
Tel. 02 75 16 120  
Fax 02 75 16 161  
metalwork@metalworkpneumatic.be

 **DENMARK**  
Metal Work Danmark A/S  
Korskildelund 1  
2670 Greve - Denmark  
Tel. 70 22 23 11  
Fax 70 22 27 59  
metalwork@metalwork.dk

 **FINLAND**  
Metal Work Finland OY  
Läkkisepäntie 4  
00620 Helsinki - Finland  
Tel. 09 731 38 270  
Fax 09 272 2712  
metalwork@metalwork.fi

 **FRANCE**  
Metal Work France Sarl  
Parc d'Activités de  
l'Esplanade  
14 Rue Enrico Fermi  
77462 Saint Thibault des Vignes  
France  
Tel. 01 60 94 00 00  
Fax 01 60 94 01 94  
metalwork@metalwork.fr  
**AGENCE SUD-EST**  
Parc du Chêne  
7/9 Rue du 35<sup>ème</sup>  
Régiment d'Aviation - BP 50  
69672 Bron Cedex - France  
Tel. 04 72 15 00 00  
Fax 01 60 94 01 94

 **GERMANY**  
Metal Work Deutschland GmbH  
Keltenstrasse 3a  
85095 Denkendorf  
Germany  
Tel. 08466 9514-0  
Fax 08466 9514-26  
metalwork@metalwork.de

 **HOLLAND**  
Metal Work Nederland B.V.  
Postbus 90 - 6710 BB EDE  
Voltastraat 9 - 6716 AJ EDE  
Holland  
Tel. 0031 0318 66 51 11  
Fax 0031 0318 66 51 15  
metalwork@metalwork.nl

 **POLAND**  
Metal Work Polska Sp Z.o.o.  
Ul. Bystra 15 A - 61-366  
Poznan - Poland  
Tel. 0 61 65 01 840  
Fax 0 61 65 01 849  
metalwork@metalwork.pl

 **PORTUGAL**  
Metal Work Portugal Lda  
Estrada Nacional, 1  
P.C. Emiauto Pav-D Sobreiro Torio  
3850 - Albergaria a Velha - Portugal  
Tel. 0035 12 34 52 54 25  
Fax 0035 12 34 52 54 26

 **SPAIN**  
Metal Work Iberica S.A.  
Pol. Ind. Can Magí  
c/Can Magí, 9  
08210 Barbera del Valles  
(Barcelona) Spain  
metalwork@metalwork.es  
Tel. 937 180 244  
Fax 937 188 070

**DELEGACION NORTE**  
Tel. 946 203 999  
Fax 946 202 642  
48220 Abadiño (Bizkaia)  
**DELEGACION CENTRO**  
Tel. 91 658 60 48  
Fax 91 658 63 51  
28700 Sebastian de los  
Reyes (Madrid)  
**DELEGACION LEVANTE**  
Tel. 96 510 62 92  
Fax 96 510 62 93  
03113 Alicante

 **SWEDEN**  
Metal Work Sverige AB  
Modemgatan, 7  
235 39 Vellinge - Sweden  
Tel. 040 42 07 00  
Fax 040 42 07 20  
metalwork@metalwork.se

 **UK**  
Metal Work Uk Ltd  
Blackhill drive - Wolverton Mill  
Milton Keynes - MK 12 5TS  
Tel. 01908 22 22 88  
Fax 01908 22 28 24  
sales@metalwork.co.uk

 **UKRAINE**  
Metal Work Ukraina  
B. Chmielnickiego str. 106  
70024 Lviv - Ukraine  
Tel. +380 32 245 94 34  
Fax +380 32 245 94 35

 **ITALIA**  
P Service Group  
www.pservice.it



**AMERICAS**

 **BRAZIL**  
Metal Work Dover do Brasil  
RIO GRANDE DO SUL  
Av. Thomaz Edison, 2648  
Scharlau CEP. 93125 - 140  
São Leopoldo/RS - Brazil  
Tel. 0055 51 3590 - 7100  
Fax 0055 51 3590 - 7111  
metalwork@metalwork.com.br

 **USA**  
Metal Work Pneumatic USA, Inc.  
1120 Eden Road, Suite 106  
Arlington, TX 76001  
Tel. 817 - 701 - 4000  
Fax 817 - 701 - 4004  
metalwork@metalwork.org

**ASIA - OCEANIA**

 **AUSTRALIA**  
Metal Work AUSTRALASIA PTY Ltd  
P.O. Box 2638  
North Parramatta 1750  
Unit 1/6 Hume Road  
Smithfield NSW 2164  
Tel. 61 2 97 25 35 99  
Fax 61 2 97 25 23 61  
metalworksydney@optusnet.com.au  
**VICTORIA BRANCH**  
N 10 Mickle Street  
Dandenong VIC 3175  
Australia  
Tel. 03 97 06 67 18  
Fax 03 97 06 67 19

 **CHINA**  
Metal Work Pneumatic Components  
(Shanghai) Co., Ltd.  
Block C1, N°3, Fulian third  
Road  
201906 - Baoshan District,  
Shanghai - China  
Tel. 0086-21-36043088  
Fax 0086-21-36043077

 **MALAYSIA**  
Metal Work Pneumatic  
(Malaysia) Sdn Bhd  
52 Jalan TPJ 5 - Taman  
Perindustrian Jaya  
47200 Petaling Jaya  
Selangor - Malaysia  
Tel. 0060 37 84 54 228  
Fax 0060 37 84 50 228  
mwpmal@streamyx.com

 **THAILAND**  
Metal Work Pneumatic  
(Thailand) Co. Ltd  
29/67 Moo 2, 345 Road  
Lumpo, Bangbuatong,  
Nonhaburi 11110  
Thailand  
Tel. 00662 961 7000  
Fax 00662 961 7227  
metalwork@metalwork.co.th



## FOREIGN AUTHORISED DEALER

### EUROPE

#### BULGARIA

TechnoKom Co Ltd  
4, Naycho Tzanov str.  
4000 Plovdiv - Bulgaria  
Tel. 00359 32 665 088  
Fax 00359 32 665 099  
www.technokom.bg  
info@technokom.bg

#### CYPRUS

Andreas Chr. - Demetriades Ltd.  
Eakos Street n°3 - Pallouriotissa  
P.O. Box 29068  
1620 Nicosia - Cyprus  
Tel. 00357 22 43 14 50 (4 lines)  
Fax 00357 22 43 73 15  
a.c.demetriades@cytanet.com.cy

#### EIRE

Pneumatics Ltd  
Old Naas Road - Bluebell  
Dublin 12 - Eire  
Tel. 003531 45 68 111  
Fax 003531 45 68 108

#### GREECE

Har. E. Akritidis & Co.  
26 Str. Monastiriou  
P.O. Box 1284 - PC 57022  
Thessaloniki - Grecia  
Tel. 0030 23 10 52 24 11  
Fax 0030 23 10 53 59 92  
akritidi@otenet.gr

#### MACEDONIA

Devit Compressor and  
Pneumatic Systems  
Ul. Razlovecko Vostante 24/13  
MK - 1000 SKOPJE - Macedonia  
Tel. 0038 97 02 25 674  
Fax 0038 92 36 15 48  
devit@unet.com.mk

#### NORWAY

SERVI MOTION CONTROL AS  
Org. nr. 936 370 446  
Haugenvn 2, Pb. 3230,  
1402 SKI - Norway  
Tel. 64 97 97 97  
Fax 64 97 98 99  
www.servi.no  
servi@servi.no  
**TESS ENGRAS AS**  
Postboks 1540  
N-3007 Drammen - Norway  
Tel. 32 84 40 00  
Fax 32 84 40 01  
www.tess.no  
ts@tess.no

#### CZECH REPUBLIC and SLOVAKIA

VT-FLEX s.r.o.  
Tesinska 288  
739 34 Senov  
Czech Republic  
Tel. 00420 59 67 48 577  
Fax 00420 59 67 28 010  
www.vt-flex.com  
sales@vt-flex.com

#### ROMANIA

Novo trade s.r.l.  
Str. Libertatii, 315  
Apahida, Cluj - Romania  
Tel. 00 40 264-434100  
Fax 00 40 264-406613  
novotech@novotech.ro

#### SLOVENIA, CROATIA and SERBIA

Lipro d.o.o.  
Ulica 15.maja 22 - 6000 Koper  
Capodistria - Slovenia  
Tel. 0038 65 62 51 343  
Fax 0038 65 62 51 344  
lipro@siol.net

#### SWITZERLAND

Tri-Matic AG  
Bösch 82 - CH 6331  
Hünenberg - Switzerland  
Tel. 0041 41 780 22 22  
Fax 0041 41 780 03 60  
www.tri-matic.ch  
info@tri-matic.ch

#### TURKEY

HPA Teknoloji Geliştirme Makina ve  
Yedek Parça İmalat  
San. İç ve Dış Tic. Ltd. Şti.  
1201/1 Sokak No: 4/A  
P21 Yenisehir - Izmir - Turkey  
Tel. 0090 232 469 7961  
449 33 92  
449 0962  
449 36 01  
Fax 0090 232 433 9625  
457 17 89

#### HUNGARY

ENTRA-SYS KFT  
H-6724 Szeged - Hungary  
Tel. 0036 62 468 478  
62 547 267  
62 547 268  
Fax 0036 62 421 403  
www.entra-sys.hu  
entra-sys@vnet.hu

### AFRICA

#### ALGERIA

SARL DELTA CONTROL  
Rue Yahia Belhayat, 09  
16035 Hydra Alger - Algeria  
Tel. 0021 32 16 92 557  
Fax 0021 32 16 04 250  
delta\_control@hotmail.com

#### EGYPT

El Masry for Industrial Services Ltd  
5 El Wakkad Str.  
Abbassia - 11371 Cairo  
Egypt  
Tel. 00202 27 45 716  
Fax 00202 27 42 916  
t.elmasry@menanet.net

#### MAROCRO

Afric Roulement  
125 - 129, Bd. Ibn Tachfine  
Casablanca - Morocco  
Tel. 022 40 70 10 - 13  
Fax 022 40 70 14  
www.aroulement.com  
roulement@iam.net.ma

#### SOUTH AFRICA

CB Pneumatics (Pty) Ltd  
Unit 14, Southern Life Ind.  
Village Crocker Street  
Wedeville Ext 6 - Germiston  
South Africa  
Tel. 0027 11 90 25 448  
Fax 0027 11 90 24 656  
cbpneu@netactive.co.za

### AMERICAS

#### CHILE

Tecnica Thomas C.Sargent S.A.C.I.  
Av. Presidente Bulnes, 205  
Santiago - Chile  
Tel. 00562 5103043  
Fax 00562 6983989

#### ECUADOR

Ecuatoriana Industrial  
Termoveal Cia Ltda  
Concepcion 676 Y Valparasio  
Quito - Ecuador  
Tel. 0059 32 22 81 921  
Fax 0059 32 29 52 888  
e\_industrial@hotmail.com  
www.ecuatorianaindustrial.com

#### URUGUAY

Fidemar S.A.  
Minas 1634 - CP 11200  
Montevideo - Uruguay  
Tel. 598 2 40 21 717  
Fax 598 2 40 21 719  
www.fidemar.com.uy  
info@fidemar.com.uy

#### VENEZUELA

Neumatica Rotonda c.a.  
Prolongacion Av. Michelena  
C.C. Atlas, Local B-9  
Valencia, Edo. Carabobo  
Venezuela  
Tel. 0058 241 83 26 464  
Fax 0058 241 83 26 283  
www.neumaticarotonda.com  
ventas@neumaticarotonda.com

### ASIA - OCEANIA

#### UNITED ARAB EMIRATES

ACME Industrial Hardware  
Trading L.L.C.  
P.O. Box 3636  
Dubai United UAE  
Tel. 009714 22 38 897  
Fax 009714 22 16 698  
acmedxb@eim.ae

#### SOUTH KOREA

Seowon Corporation  
1001 Ilsan Technotown  
1141-1 Beksuk-Dong  
Ilsandong-Gu, Goyang City  
Gyunggi-Do 410-722  
South Korea  
Tel. 0082 31 90 61 100  
Fax 0082 31 90 61 101  
mail@seowoncorp.com  
www.seowoncorp.com

#### ISRAEL

Conlog Ltd  
7 Leshem St.  
49134 Petach Tikva - Israel  
Tel. 00972 3 92 69 595  
Fax 00972 3 92 33 367  
www.conlog.co.il  
conlog@conlog.co.il

#### TAIWAN

Century Automatiom Corporation  
5F-8, no.1 Wu-Chuan 1  
St.Road Hsin  
Taipei Hsien- Taiwan  
Tel. 00886222988436  
Fax 00886222988436  
century@cenauto.com.tw

## THE METAL WORK SOLUTION WITH CAPTIVATED O-RING

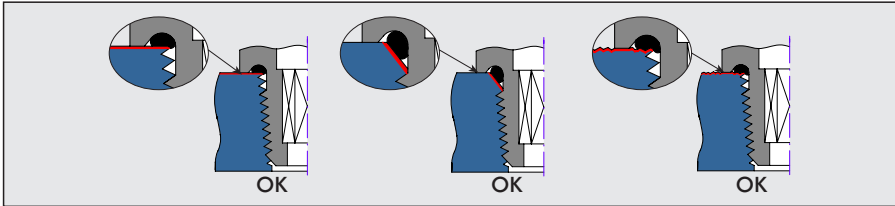

- Perfect seal even on flat, conical and raw surfaces.

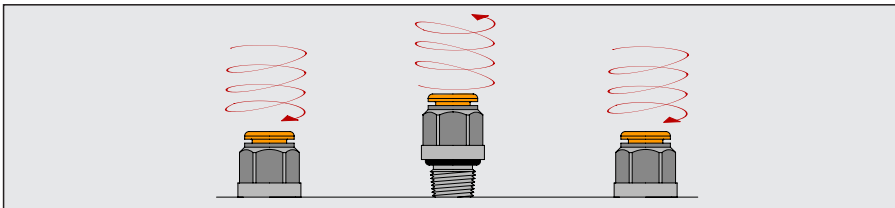

- Can be re-used thousands of times.

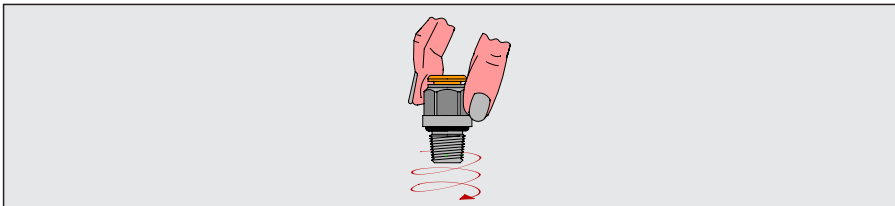

- The pneumatic seal is obtained by simply screwing the fitting in by hand. Tighten firmly without forcing to prevent unscrewing.

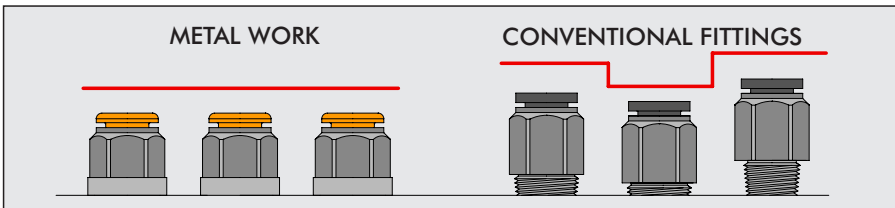

- Constant height of the mounted fitting irregardless of the tolerance of the thread, or to the torque.

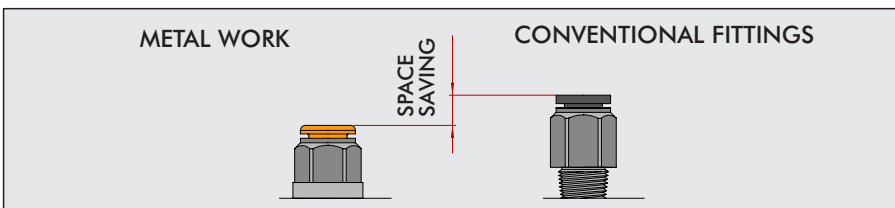

- Reduced fitting height

## THE NEW SOLUTION OFFERS NUMEROUS ADVANTAGES OVER CONVENTIONAL SOLUTIONS:

### Solution with **NPTF Dry seal thread**

- It operates correctly if the male and female thread are made exactly to standard, otherwise there will be air leaks.

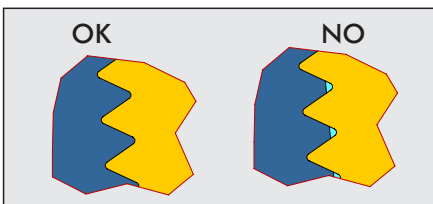

### Solution with **thread coated with teflon or other sealant**

- A limited number of assemblies is possible after which there will be no seal.
- Particles of sealant detach from the fitting or enter the compressed air system, which affects cleanness of the compressed air.

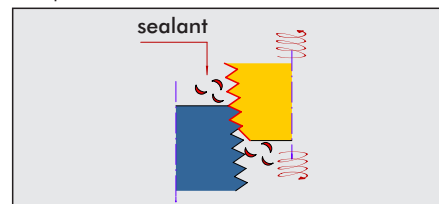

### Solution with **teflon or rubber ring on the thread**

- Guaranteed seal with just a few turns.

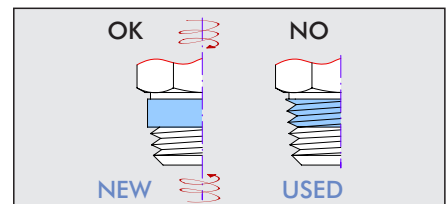

## OTHER ADVANTAGES OF METAL WORK FITTINGS

- Tighten by open end or box wrench

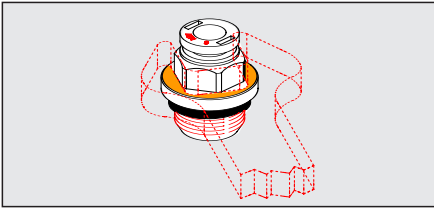

- Tighten by allen wrench, available in straight configuration

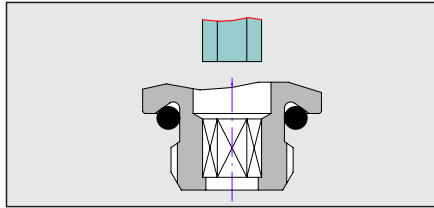

- Slot to facilitate release with a screw driver

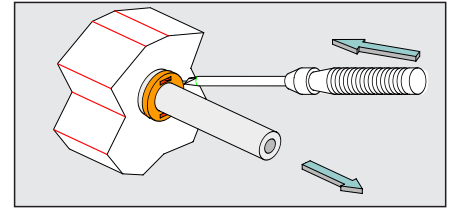

## GENERAL FEATURES

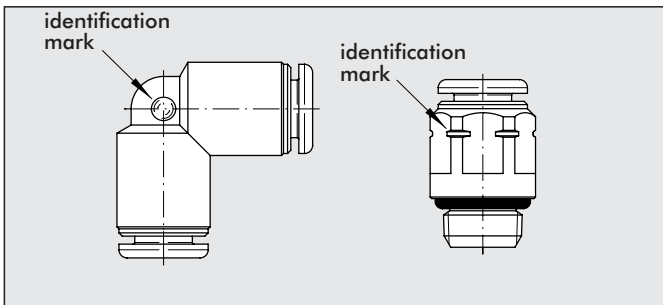

Identification mark for fractional pipe fittings in inches or with NPT thread. NB: threadless fittings for 1/8, 5/32 and 5/16 pipes do not bear an identification mark as they are used in Europe.

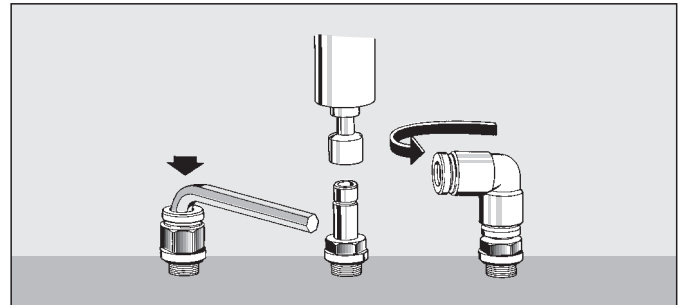

Mounting fittings with an Allen wrench or pneumatic tool. All the elbows and tees are rotary. Drastic reduction in assembly times.

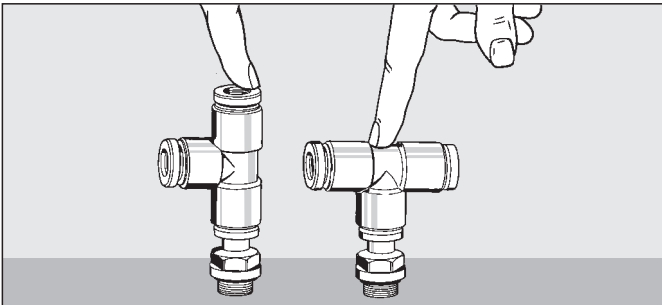

A single tee can give central tees and lateral tees.

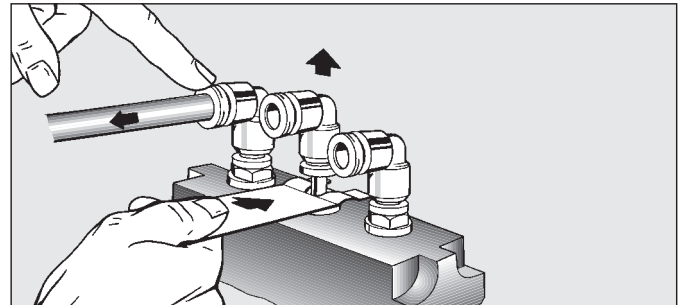

The pipe is easy to assemble by pressing lightly on the pusher ring. To remove the fitting, merely push radially on the key.

## FROM AN IDEA, A SYSTEM

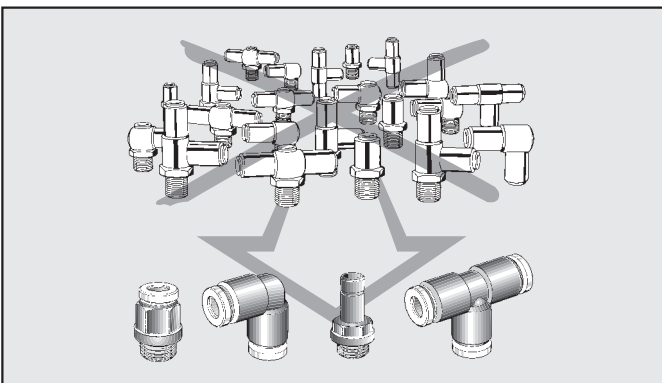

- Four basic fittings can be used to make all possible connections in a pneumatic circuit.
- Sharp drop in the number of fittings to be stocked and hence reduced operating costs.

**ASSEMBLY DIAGRAM**

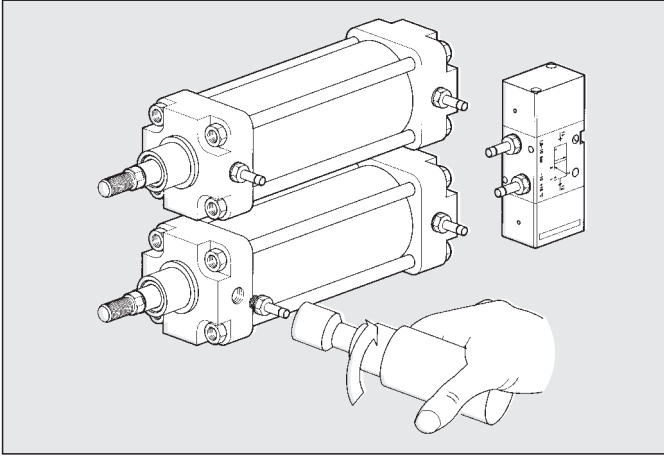

Pre-assembling fittings on the workbench with a pneumatic tool even with very close center distances.

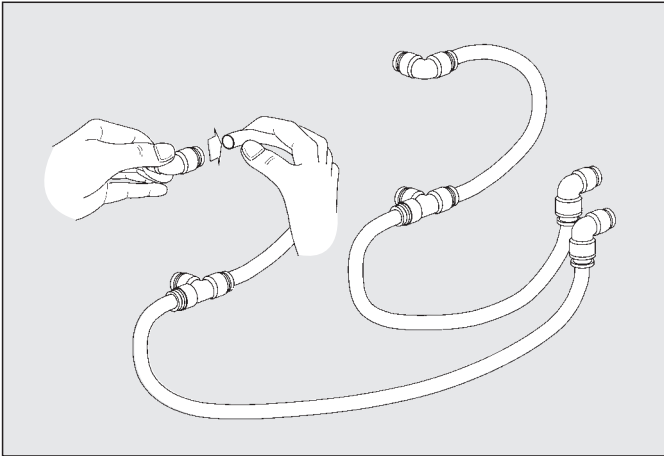

Pre-assembling fittings and pipe sections on the workbench. Pre-assembled configurations can be stocked for assembly in series.

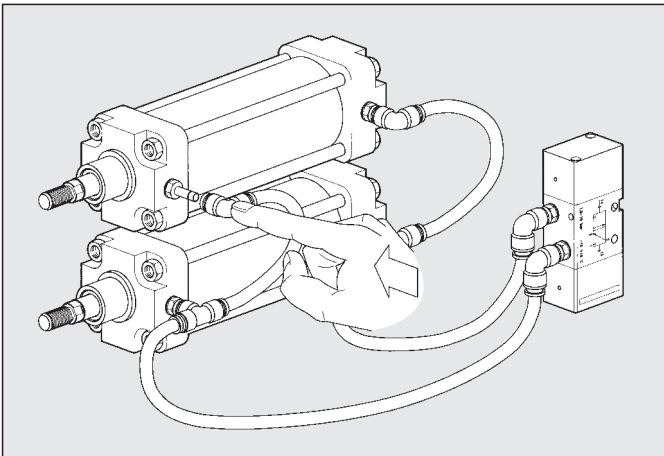

Quick connection and completion of the pneumatic circuit.

**FROM A SYSTEM, INNOVATION**

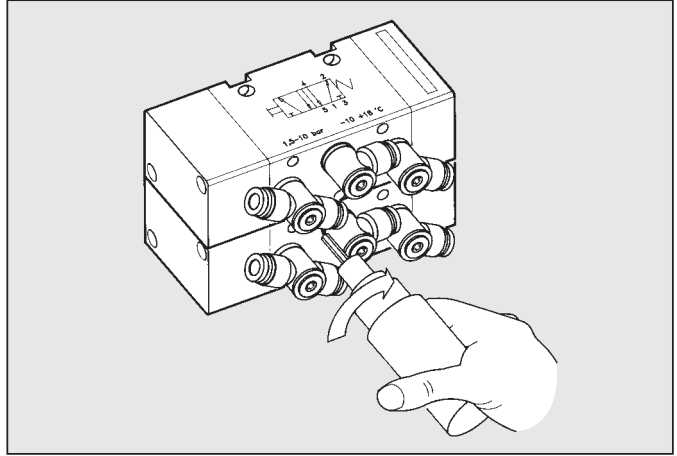

An Allen wrench is used to assemble rotary fittings even with very close center distances.

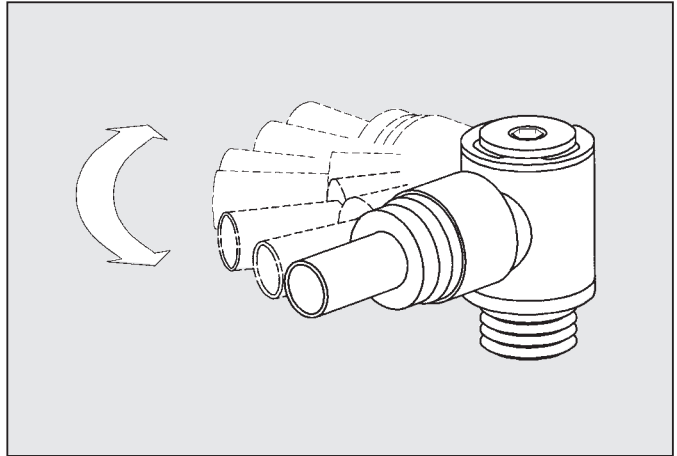

The special configuration with two O-rings allows maximum orientation so as to follow pipe movement in the specific application.

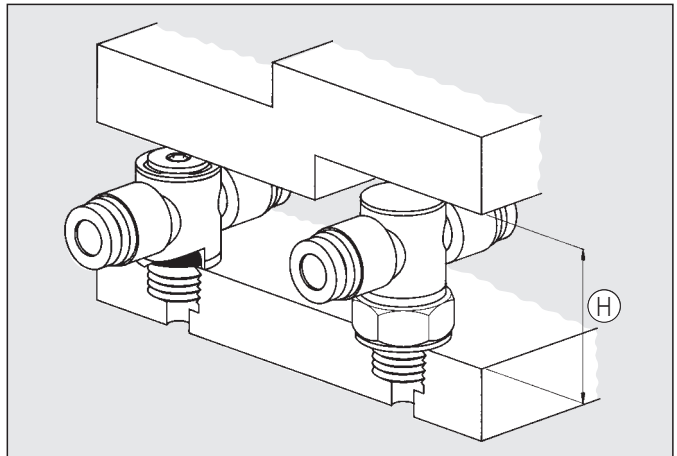

Fittings with a built-in gasket and reduced height (H) with the same threaded coupling and pipe diameter.

# NPT TUBE FITTINGS

## RU1 - MALE CONNECTORS

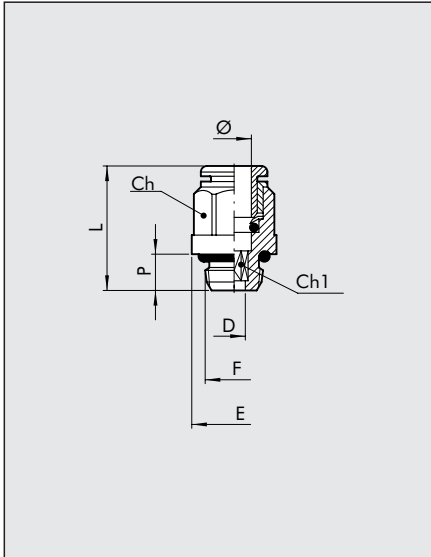

MW Part. No.	Ref	ø	F	Ch		Ch1		P	L	D	E
				Inc	mm	Inc	mm				
2U01A02	RU1	1/8	10/32 UNF	—	—	5/64	2	0,14	0,51	0,08	0,23
2U01A03	RU1	1/8	1/8 NPT	5/16	8	5/64	2	0,24	0,54	0,08	0,51
2U01001	RU1	5/32	10/32 UNF	—	—	5/64	2	0,16	0,77	0,08	0,35
2U01002	RU1	5/32	1/8 NPT	0,394	10	0,118	3	0,24	0,68	0,12	0,51
2U01003	RU1	5/32	1/4 NPT	0,394	10	0,118	3	0,31	0,72	0,12	0,65
2U01000	RU1	1/4	10/32 UNF	—	—	5/64	2	0,16	0,84	0,08	0,43
2U01007	RU1	1/4	1/8 NPT	0,472	12	0,157	4	0,24	0,81	0,16	0,51
2U01008	RU1	1/4	1/4 NPT	0,472	12	0,157	4	0,31	0,76	0,16	0,65
2U01020	RU1	1/4	3/8 NPT	0,472	12	0,157	4	0,35	0,81	0,16	0,79
2U01009	RU1	5/16	1/8 NPT	0,512	13	0,197	5	0,24	0,96	0,20	0,55
2U01010	RU1	5/16	1/4 NPT	0,551	14	0,236	6	0,31	0,96	0,24	0,65
2U01011	RU1	5/16	3/8 NPT	0,551	14	0,236	6	0,35	0,86	0,24	0,79
2U01012	RU1	3/8	1/4 NPT	5/8	16	0,276	7	0,31	1,12	0,28	0,69
2U01013	RU1	3/8	3/8 NPT	5/8	16	5/16	8	0,35	1,02	0,32	0,79
2U01021	RU1	3/8	1/2 NPT	5/8	16	5/16	8	0,43	1,04	0,32	0,96
2U01014	RU1	1/2	3/8 NPT	0,866	22	0,394	10	0,35	1,28	0,4	0,79
2U01015	RU1	1/2	1/2 NPT	0,866	22	0,394	10	0,43	1,18	0,4	0,96

## RU2 - FEMALE CONNECTORS

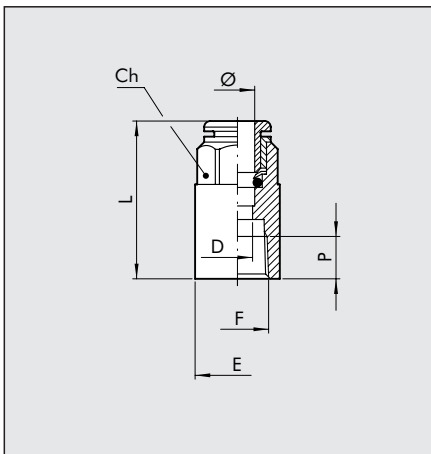

MW Part. No.	Ref	ø	F	Ch		P	L	D	E
				Inc	mm				
2U02A03	RU2	1/8	1/8 NPT	5/16	8	0,28	0,82	0,09	0,55
2U02001	RU2	5/32	1/8 NPT	0,394	10	0,28	1,02	0,12	0,55
2U02002	RU2	5/32	1/4 NPT	0,394	10	0,28	1,09	0,12	0,67
2U02005	RU2	1/4	1/8 NPT	0,472	12	0,28	1,03	0,20	0,55
2U02006	RU2	1/4	1/4 NPT	0,472	12	0,28	1,11	0,20	0,67
2U02007	RU2	5/16	1/8 NPT	0,512	13	0,28	1,07	0,28	0,55
2U02008	RU2	5/16	1/4 NPT	0,551	14	0,28	1,15	0,28	0,67

## RU3 - STRAIGHT UNION

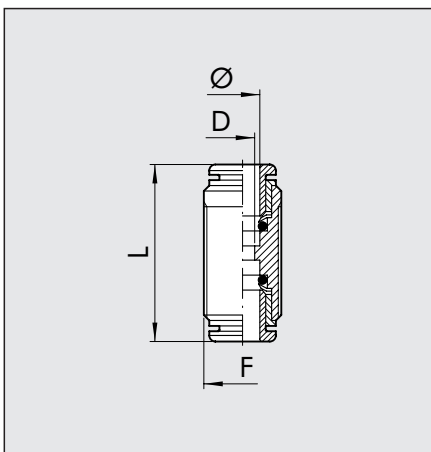

MW Part. No.	Ref	ø	F	L	D
2003A01	R3	1/8	M8X0.75	0,72	0,08
2L03001	RL3	5/32	M11X1	1,13	0,10
2U03003	RU3	1/4	M13X1	1,23	0,18
2L03004	RL3	5/16	M15X1	1,33	0,26
2U03005	RU3	3/8	M17X1	1,49	0,31
2U03006	RU3	1/2	M22X1	1,7	0,39

### RU16 - ROTARY FITTINGS DOUBLE

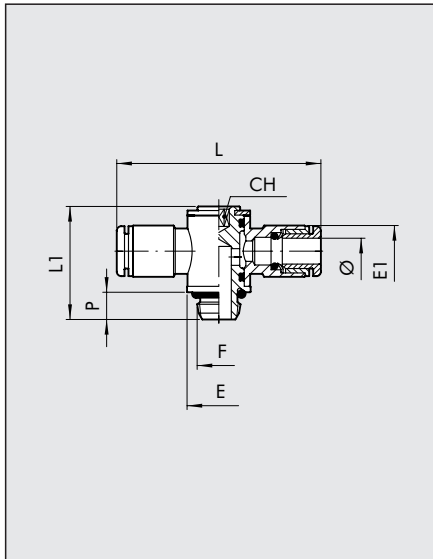

MW Part. No.	Ref.	ø	F	Ch		P	L	L1	E	E1
				Inc	mm					
2U15001	RU16	5/32	10/32 UNF	5/64	2	0,16	1,51	0,74	0,31	0,37
2U15002	RU16	5/32	1/8 NPT	5/64	2	0,24	1,47	1,01	0,51	0,37
2U15106	RU16	1/4	10/32 UNF	0,118	3	0,16	1,77	0,74	0,31	0,46
2U15005	RU16	1/4	1/8 NPT	5/64	2	0,24	1,77	1,01	0,51	0,46
2U15007	RU16	1/4	1/4 NPT	0,118	3	0,31	1,91	1,17	0,65	0,46
2U15006	RU16	5/16	1/8 NPT	5/32	4	0,24	1,91	1,01	0,51	0,54
2U15008	RU16	5/16	1/4 NPT	0,118	3	0,31	2,04	1,17	0,65	0,54
2U15013	RU16	5/16	3/8 NPT	5/32	4	0,35	2,21	1,40	0,79	0,54
2U15009	RU16	3/8	1/4 NPT	0,197	5	0,31	2,46	1,17	0,65	0,65
2U15014	RU16	3/8	3/8 NPT	5/32	4	0,35	2,53	1,40	0,79	0,63
2U15011	RU16	1/2	3/8 NPT	0,197	5	0,35	2,88	1,4	0,79	0,79
2U15012	RU16	1/2	1/2 NPT	0,315	8	0,43	3	1,6	0,96	0,8

### RU31 - MALE ELBOWS

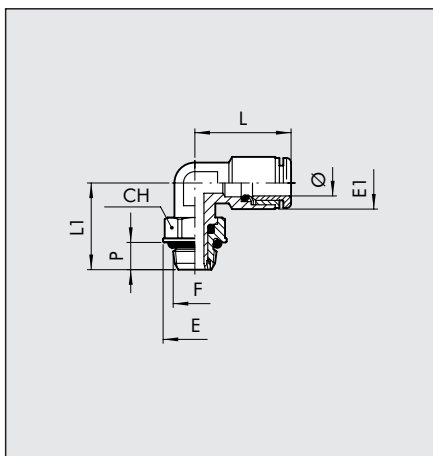

MW Part. No.	Ref.	ø	F	Ch		P	L	L1	E	E1
				Inc	mm					
2U31001	RU31	5/32	10/32 UNF	0,354	9	0,16	0,69	0,60	0,39	0,37
2U31002	RU31	5/32	1/8 NPT	0,472	12	0,24	0,69	0,75	0,51	0,37
2U31003	RU31	5/32	1/4 NPT	0,551	14	0,31	0,69	0,83	0,65	0,37
2U31007	RU31	1/4	10/32 UNF	0,354	9	0,16	0,82	0,60	0,39	0,46
2U31008	RU31	1/4	1/8 NPT	0,472	12	0,24	0,82	0,75	0,51	0,46
2U31009	RU31	1/4	1/4 NPT	0,551	14	0,31	0,82	0,83	0,65	0,46
2U31010	RU31	5/16	1/8 NPT	0,472	12	0,24	0,96	0,75	0,51	0,54
2U31011	RU31	5/16	1/4 NPT	0,551	14	0,31	0,96	0,83	0,65	0,54
2U31012	RU31	5/16	3/8 NPT	0,669	17	0,35	0,93	1,07	0,79	0,54
2U31013	RU31	3/8	1/4 NPT	0,551	14	0,31	1,04	0,86	0,65	0,63
2U31014	RU31	3/8	3/8 NPT	0,669	17	0,35	1,04	1,07	0,79	0,63
2U31015	RU31	3/8	1/2 NPT	0,866	22	0,43	1,04	1,18	0,96	0,63
2U31017	RU31	1/2	3/8 NPT	0,67	17	0,35	1,19	1,11	0,79	0,79
2U31018	RU31	1/2	1/2 NPT	0,866	22	0,43	1,19	1,2	0,96	0,79

### RU32 - BRANCH TEES

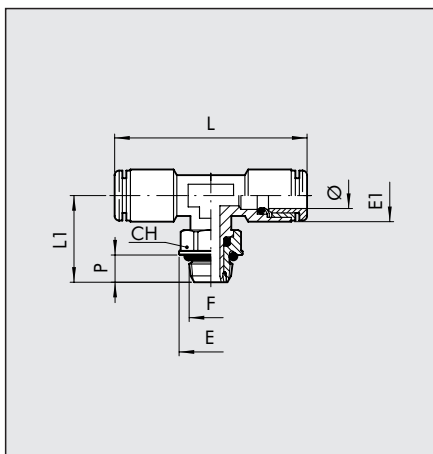

MW Part. No.	Ref.	ø	F	Ch		P	L	L1	E	E1
				Inc	mm					
2U32002	RU32	5/32	1/8 NPT	0,472	12	0,24	1,39	0,75	0,51	0,37
2U32003	RU32	5/32	1/4 NPT	0,551	14	0,31	1,39	0,83	0,65	0,37
2U32008	RU32	1/4	1/8 NPT	0,472	12	0,24	1,65	0,75	0,51	0,46
2U32009	RU32	1/4	1/4 NPT	0,551	14	0,31	1,65	0,83	0,65	0,46
2U32010	RU32	5/16	1/8 NPT	0,472	12	0,24	1,91	0,75	0,51	0,54
2U32011	RU32	5/16	1/4 NPT	0,551	14	0,31	1,91	0,83	0,65	0,54
2U32012	RU32	5/16	3/8 NPT	0,669	17	0,35	1,87	1,07	0,79	0,54
2U32013	RU32	3/8	1/4 NPT	0,551	14	0,31	2,09	0,86	0,65	0,63
2U32014	RU32	3/8	3/8 NPT	0,669	17	0,35	2,09	1,07	0,79	0,63
2U32015	RU32	3/8	1/2 NPT	0,866	22	0,43	2,08	1,18	0,96	0,63
2U32017	RU32	1/2	3/8 NPT	0,67	17	0,35	2,38	1,11	0,79	0,79
2U32018	RU32	1/2	1/2 NPT	0,866	22	0,43	2,38	1,2	0,96	0,79

### RU54 - SINGLE BANJO

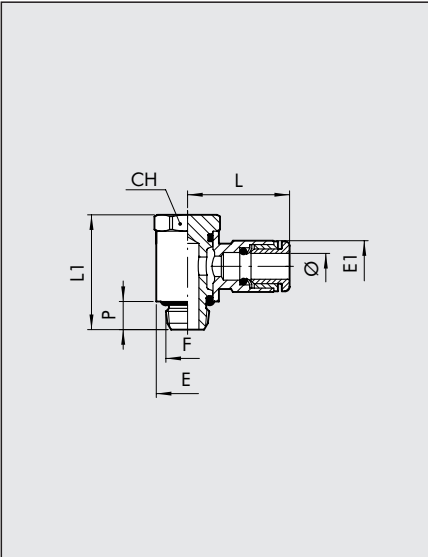

MW Part. No.	Ref.	ø	F	Ch		P	L	L1	E	E1
				Inc	mm					
2U54001	RU54	5/32	10/32 UNF	0,354	9	0,18	0,76	0,74	0,37	0,37
2U54002	RU54	5/32	1/8 NPT	0,512	13	0,24	0,74	0,99	0,55	0,37
2U54007	RU54	1/4	10/32 UNF	0,354	9	0,18	0,89	0,74	0,37	0,46
2U54008	RU54	1/4	1/8 NPT	0,512	13	0,24	0,89	0,99	0,55	0,46
2U54009	RU54	1/4	1/4 NPT	5/8	16	0,32	0,95	1,15	0,71	0,46
2U54010	RU54	5/16	1/8 NPT	0,512	13	0,24	0,95	0,99	0,55	0,54
2U54011	RU54	5/16	1/4 NPT	5/8	16	0,32	1,02	1,15	0,71	0,54
2U54012	RU54	5/16	3/8 NPT	0,787	20	0,35	1,11	1,39	0,83	0,54
2U54013	RU54	3/8	1/4 NPT	5/8	16	0,32	1,23	1,15	0,71	0,63
2U54014	RU54	3/8	3/8 NPT	0,787	20	0,35	1,26	1,39	0,83	0,63
2U54016	RU54	1/2	3/8 NPT	0,787	20	0,39	1,44	1,39	0,83	0,8
2U54017	RU54	1/2	1/2 NPT	0,984	25	0,49	1,5	1,57	1,02	0,8

### RU55 - DOUBLE BANJO

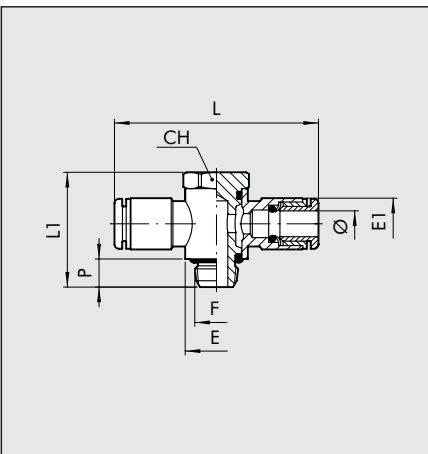

MW Part. No.	Ref.	ø	F	Ch		P	L	L1	E	E1
				Inc	mm					
2U55001	RU55	5/32	10/32 UNF	0,354	9	0,18	1,51	0,74	0,37	0,37
2U55002	RU55	5/32	1/8 NPT	0,512	13	0,24	1,47	0,99	0,55	0,37
2U55007	RU55	1/4	10/32 UNF	0,354	9	0,18	1,77	0,74	0,37	0,46
2U55008	RU55	1/4	1/8 NPT	0,512	13	0,24	1,77	0,99	0,55	0,46
2U55009	RU55	1/4	1/4 NPT	5/64	16	0,32	1,91	1,15	0,71	0,46
2U55010	RU55	5/16	1/8 NPT	0,512	13	0,24	1,91	0,99	0,55	0,54
2U55011	RU55	5/16	1/4 NPT	5/64	16	0,32	2,04	1,15	0,71	0,54
2U55012	RU55	5/16	3/8 NPT	0,787	20	0,35	2,21	1,39	0,83	0,54
2U55013	RU55	3/8	1/4 NPT	5/64	16	0,32	2,46	1,15	0,71	0,63
2U55014	RU55	3/8	3/8 NPT	0,787	20	0,35	2,53	1,39	0,83	0,63
2U55016	RU55	1/2	3/8 NPT	0,787	20	0,39	2,88	1,39	0,83	0,8
2U55017	RU55	1/2	1/2 NPT	0,984	25	0,49	3	1,57	1,02	0,8

### RU56 - DOUBLE STACKING BANJO, 2 PIPE CONNECTIONS

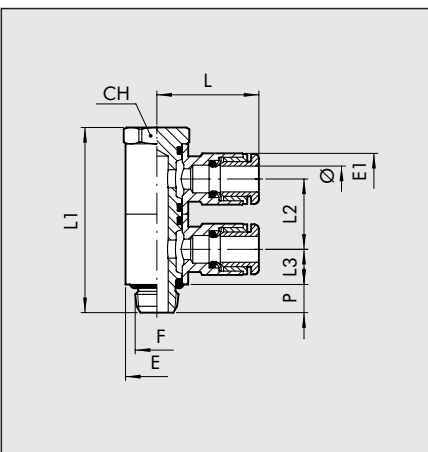

MW Part. No.	Ref.	ø	F	Ch		P	L	L1	L2	L3	E	E1
				Inc	mm							
2U56001	RU56	5/32	10/32 UNF	0,354	9	0,18	0,76	1,19	0,45	0,23	0,37	0,37
2U56002	RU56	5/32	1/8 NPT	0,512	13	0,24	0,74	1,60	0,61	0,31	0,55	0,37
2U56007	RU56	1/4	10/32 UNF	0,354	9	0,18	0,89	1,19	0,45	0,23	0,37	0,46
2U56008	RU56	1/4	1/8 NPT	0,512	13	0,24	0,89	1,60	0,61	0,31	0,55	0,46
2U56009	RU56	1/4	1/4 NP	5/8	16	0,32	0,95	1,83	0,68	0,34	0,71	0,46
2U56010	RU56	5/16	1/8 NPT	0,512	13	0,24	0,95	1,60	0,61	0,31	0,55	0,54
2U56011	RU56	5/16	1/4 NPT	5/8	16	0,32	1,02	1,83	0,68	0,34	0,71	0,54
2U56012	RU56	5/16	3/8 NPT	0,787	20	0,35	1,11	2,24	0,84	0,42	0,83	0,54
2U56013	RU56	3/8	1/4 NPT	5/8	16	0,32	1,23	1,83	0,68	0,34	0,71	0,63
2U56014	RU56	3/8	3/8 NPT	0,787	20	0,35	1,26	2,24	0,84	0,42	0,83	0,63
2U56016	RU56	1/2	3/8 NPT	0,787	20	0,39	1,44	2,24	0,84	0,42	0,83	0,8
2U56017	RU56	1/2	1/2 NPT	0,984	25	0,49	1,5	2,52	0,94	0,47	1,02	0,8

# PUSH-IN FITTINGS

Metal Work fittings are the best elements for connecting pipes and actuators. Quick and easy to use, the Metal Work push-in fittings can be re-used thousands of times without affecting the pneumatic and mechanical seal in any way. It comes in various configurations and guarantees a virtually unlimited, highly flexible use. The clamping spring with its special shape grips the pipe without scratching or deforming it, which facilitates release. In the RL fittings Ø4 and Ø8, the release bushing has patented screwdriver slots to facilitate release in applications not accessible by hand. The seal of the thread is guaranteed due to a special, captivated, O-ring integral to the fitting.



TECHNICAL DATA		
Threaded coupling		10/32 UNF - 1/8 NPT - 1/4 NPT - 3/8 NPT - 1/2 NPT
Diameter	mm	1/8 - 5/32 - 1/4 - 5/16 - 3/8 - 1/2
Temperature range	°C	-20°C ÷ 70°C
	°F	-4°F ÷ 158°F
Pressure range	psi	-14... to ...260
	bar	-0,99... to ...18
Recommended pipe		Rilsan PA 11 - Nylon 6 - Polyamide 12 - Polypropylene
Fluid		Vacuum - Compressed air

## COMPONENTS

- ① Release button: technopolymer
- ② Stop button: brass
- ③ Body: nickel-plated brass
- ④ Spring: stainless steel (for pipes Ø1/8: brass gripper)
- ⑤ Spring ring: technopolymer
- ⑥ O-ring Seals: Buna-N
- ⑦ NPT thread

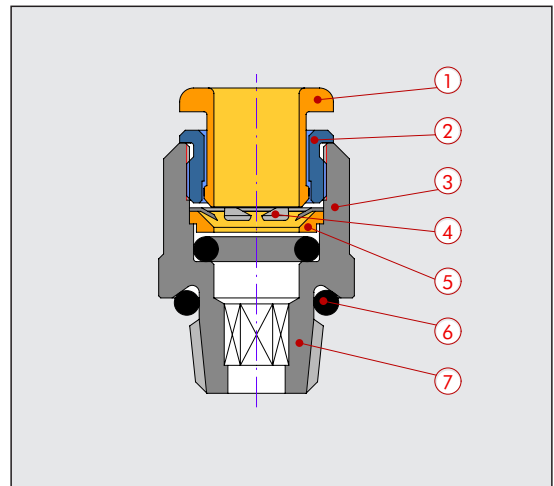

## NOTES

## O-RING BELOW R FITTINGS

Thread	Initials	Dimensions of O-ring
1/8	2031	7.66x1.78
1/4	2043	10.82x1.78
3/8	2056	14x1.78
1/2	3068	17.13x2.62

## SCREWING METHOD

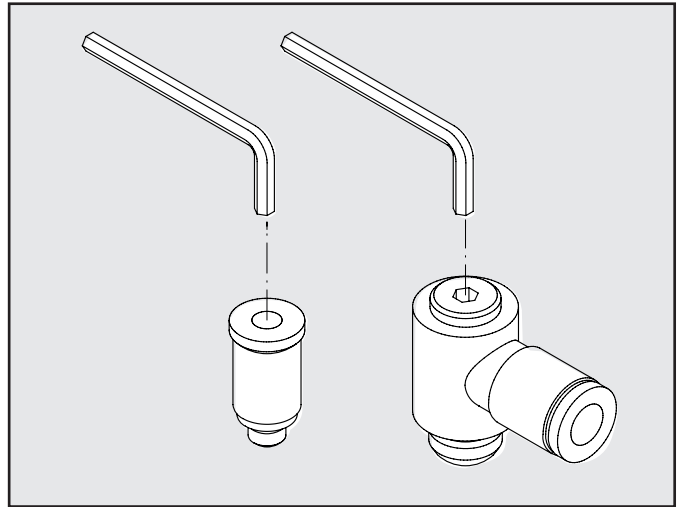
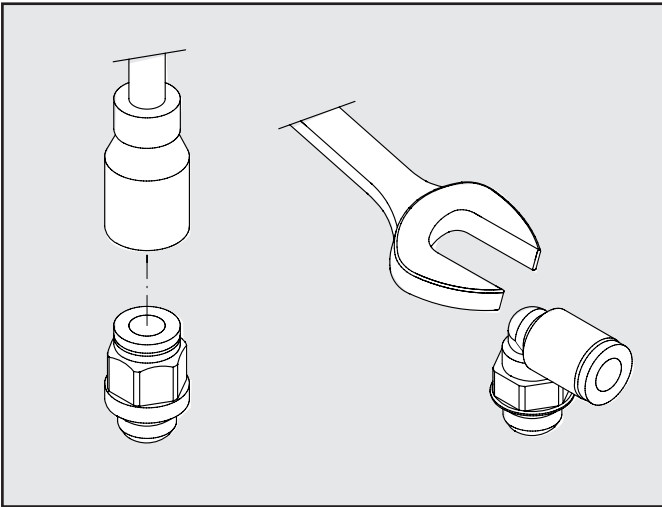

Thread	Max. Torque [lb f ft]
10/32	1.33
1/8" NPT	4.33
1/4" NPT	5.90
3/8" NPT	7.38
1/2" NPT	11.06

Ch		Max. Torque [lb f ft]
Inc	mm	
5/64	2	1.33
0.118	3	5.90
0.157	4	4.43
0.197	5	5.90
Over 0.197	Over 5	See the values concerning threads

NB: When using a socket spanner, the torque must not exceed that of the thread (e.g. fitting RU1 5/32 1/8 NPT, with a 0.118 inc sochet, has a maximum torque of 4.43 lb f ft).

## NOTES

### RU4 - UNION ELBOWS

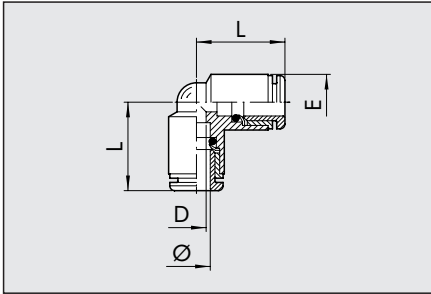

MW Part. No.	Ref.	ø	L	D	E
2004A01	R4	1/8	0,41	0,08	0,25
2L04001	RL4	5/32	0,63	0,10	0,37
2U04003	RU4	1/4	0,72	0,18	0,45
2L04004	RL4	5/16	0,81	0,26	0,53
2U04005	RU4	3/8	0,93	0,31	0,61
2U04006	RU4	1/2	1,07	0,43	0,81

### RU5 - UNION TEES

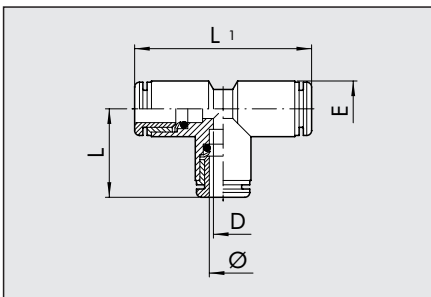

MW Part. No.	Ref.	ø	L	L1	D	E
2005A01	R5	1/8	0,41	0,82	0,08	0,25
2L05001	RL5	5/32	0,63	1,26	0,10	0,37
2U05003	RU5	1/4	0,72	1,44	0,18	0,45
2L05004	RL5	5/16	0,81	1,63	0,26	0,53
2U05005	RU5	3/8	0,91	1,82	0,31	0,61
2U05006	RU5	1/2	1,07	2,14	0,43	0,81

### RU6 - STEM ADAPTORS

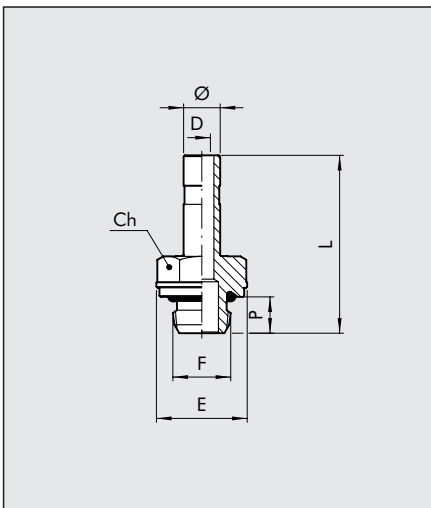

MW Part. No.	Ref.	ø	F	Ch		P	L	D	E
				Inc	mm				
2U06A01	RU6	1/8	10/32 UNF	0,197	5	0,14	0,73	0,08	0,23
2U06A02	RU6	1/8	1/8 NPT	0,472	12	0,24	0,89	0,08	0,51
2U06001	RU6	5/32	10/32 UNF	5/16	8	0,16	0,99	0,08	0,35
2U06002	RU6	5/32	1/8 NPT	0,472	12	0,24	1,09	0,10	0,51
2U06003	RU6	5/32	1/4 NPT	0,551	14	0,31	1,19	0,10	0,65
2U06000	RU6	1/4	10/32 UNF	5/16	8	0,16	1,01	0,08	0,35
2U06007	RU6	1/4	1/8 NPT	0,472	12	0,24	1,11	0,16	0,51
2U06008	RU6	1/4	1/4 NPT	0,551	14	0,31	1,20	0,16	0,65
2U06020	RU6	1/4	3/8 NPT	0,669	17	0,35	1,31	0,16	0,79
2U06009	RU6	5/16	1/8 NPT	0,472	12	0,24	1,15	0,22	0,51
2U06010	RU6	5/16	1/4 NPT	0,551	14	0,31	1,24	0,24	0,65
2U06011	RU6	5/16	3/8 NPT	0,669	17	0,35	1,35	0,24	0,79
2U06012	RU6	3/8	1/4 NPT	0,551	14	0,31	1,37	0,29	0,65
2U06013	RU6	3/8	3/8 NPT	0,669	17	0,35	1,48	0,29	0,79
2U06022	RU6	3/8	1/2 NPT	0,748	19	0,43	1,62	0,29	0,96
2U06014	RU6	1/2	3/8 NPT	0,669	17	0,35	1,55	0,41	0,79
2U06015	RU6	1/2	1/2 NPT	0,748	19	0,43	1,72	0,41	0,96

### RU7 - STRAIGHT CONNECTORS

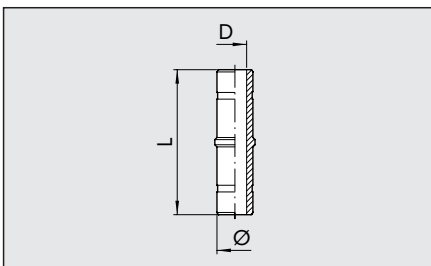

Cod.	Ref.	ø	L	D
2007001	R7	5/32	1,34	0,08
2U07003	RU7	1/4	1,40	0,16
2L07004	RL7	5/16	1,48	0,24
2U07005	RU7	3/8	1,73	0,29
2U07006	RU7	1/2	2	0,41

## RU8 - PLUG IN REDUCERS

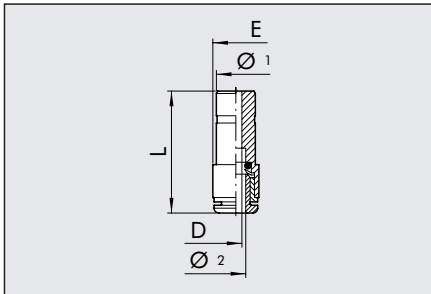

MW Part. No.	Ref.	ø1	ø2	L	D	E
2008A02	R8	5/32	1/8	1,02	0,08	0,25
2U08002	RU8	1/4	5/32	1,15	0,10	0,39
2L08004	RL8	5/16	5/32	1,09	0,10	0,37
2U08006	RU8	5/16	1/4	1,23	0,18	0,46
2U08007	RU8	3/8	1/4	1,36	0,20	0,46
2U08011	RU8	1/2	5/16	1,27	0,28	0,57
2U08015	RU8	1/2	3/8	1,4	0,31	0,63

## RU9 BLANKING PLUGS IN PLASTIC

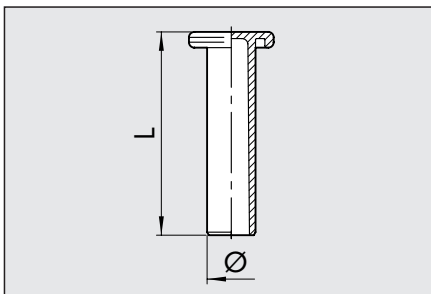

MW Part. No.	Ref.	ø	L
2L10A01	RL9T	1/8	0,77
2L10001	RL9T	5/32	1,06
2U10003	RU9	1/4	1,17
2L10004	RL9T	5/16	1,32
2U10005	RU9	3/8	1,45
2L10A01	RU9	1/2	1,54

## RU10 - BULKHEAD UNIONS

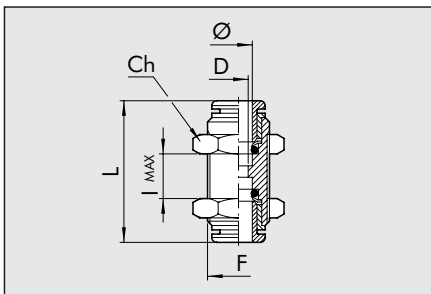

MW Part. No.	Ref.	ø	F	Ch		L	D	I max
				Inc	mm			
2011A01	R10	1/8	M8X0.75	0,394	10	0,72	0,08	0,20
2L11001	RL10	5/32	M11X1	0,512	13	1,13	0,10	0,43
2U11003	RU10	1/4	M13X1	5/8	16	1,23	0,18	0,47
2L11004	RL10	5/16	M15X1	0,669	17	1,33	0,26	0,53
2U11005	RU10	3/8	M17X1	0,787	20	1,49	0,31	0,67
2U11006	RU10	1/2	M22X1	0,984	25	1,7	0,39	0,74

## RU15 - ROTARY FITTINGS SINGLE

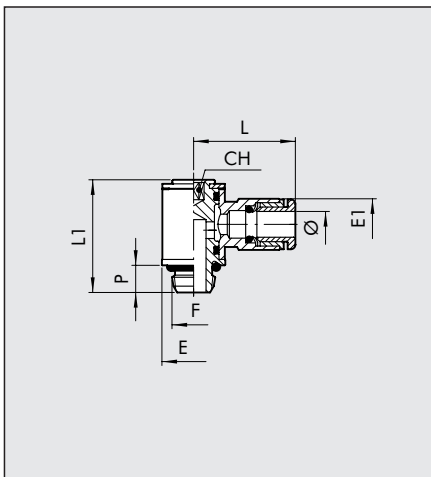

MW Part. No.	Ref.	ø	F	Ch		P	L	L1	E	E1
				Inc	mm					
2U14104	RU15	1/8	10/32 UNF	5/64	2	0,16	0,50	0,55	0,23	0,28
2U14001	RU15	5/32	10/32 UNF	5/64	2	0,16	0,76	0,74	0,31	0,37
2U14002	RU15	5/32	1/8 NPT	0,118	3	0,24	0,74	1,01	0,51	0,37
2U14106	RU15	1/4	10/32 UNF	5/64	2	0,16	0,89	0,74	0,31	0,46
2U14005	RU15	1/4	1/8 NPT	0,118	3	0,24	0,89	1,01	0,51	0,46
2U14007	RU15	1/4	1/4 NPT	5/32	4	0,31	0,95	1,17	0,65	0,46
2U14006	RU15	5/16	1/8 NPT	0,118	3	0,24	0,95	1,01	0,51	0,54
2U14008	RU15	5/16	1/4 NPT	5/32	4	0,31	1,02	1,17	0,65	0,54
2U14013	RU15	5/16	3/8 NPT	0,197	5	0,35	1,11	1,40	0,79	0,54
2U14009	RU15	3/8	1/4 NPT	5/32	4	0,31	1,23	1,17	0,65	0,65
2U14014	RU15	3/8	3/8 NPT	0,197	5	0,35	1,26	1,40	0,79	0,63
2U14011	RU15	1/2	3/8 NPT	0,197	5	0,35	1,44	1,4	0,79	0,79
2U14012	RU15	1/2	1/2 NPT	0,315	8	0,43	1,5	1,6	0,96	0,8

**RU57 - DOUBLE STACKING BANJO,  
4 PIPE CONNECTIONS**

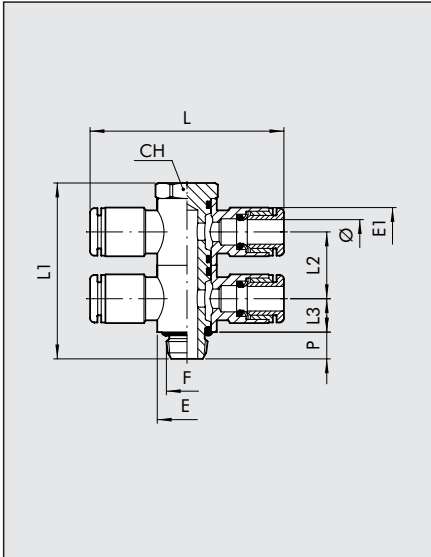

MW Part. No.	Ref.	ø	F	Ch		P	L	L1	L2	L3	E	E1
				Inc	mm							
2U57001	RU57	5/32	10/32 UNF	0,354	9	0,18	1,51	1,19	0,45	0,23	0,37	0,37
2U57002	RU57	5/32	1/8 NPT	0,512	13	0,24	1,47	1,60	0,61	0,31	0,55	0,37
2U57007	RU57	1/4	10/32 UNF	0,354	9	0,18	1,77	1,19	0,45	0,23	0,37	0,46
2U57008	RU57	1/4	1/8 NPT	0,512	13	0,24	1,77	1,60	0,61	0,31	0,55	0,46
2U57009	RU57	1/4	1/4 NPT	5/8	16	0,32	1,91	1,83	0,68	0,34	0,71	0,46
2U57010	RU57	5/16	1/8 NPT	0,512	13	0,24	1,91	1,60	0,61	0,31	0,55	0,54
2U57011	RU57	5/16	1/4 NPT	5/8	16	0,32	2,04	1,83	0,68	0,34	0,71	0,54
2U57012	RU57	5/16	3/8 NPT	0,787	20	0,35	2,21	2,24	0,84	0,42	0,83	0,54
2U57013	RU57	3/8	1/4 NPT	5/8	16	0,32	2,46	1,83	0,68	0,34	0,71	0,63
2U57014	RU57	3/8	3/8 NPT	0,787	20	0,35	2,53	2,24	0,84	0,42	0,83	0,63
2U57016	RU57	1/2	3/8 NPT	0,787	20	0,39	2,89	2,24	0,84	0,42	0,83	0,8
2U57017	RU57	1/2	1/2 NPT	0,984	25	0,49	3	2,52	0,94	0,47	1,02	0,8

## ACCESSORIES

**RL17 - DISASSEMBLY KEY**

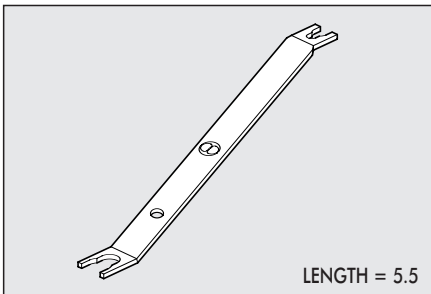

MW Part. No.	Ref.	ø tube
2L17001	RL17	from Ø 1/8 to Ø 3/8

**NOTES**

# NPT FITTINGS SERIES A

## AU5/G - NPT FEMALE BSP MALE ADAPTORS

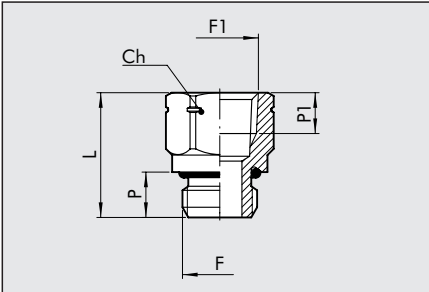

MW Part. No.	Ref.	F	F1	Ch		P	P1	L
				Inc	mm			
2105100U	AU5/G	M5	10/32 UNF	5/16	8	0,16	0,18	0,46
2105101U	AU5/G	G1/8	1/8 NPT	0,551	14	0,24	0,28	0,73
2105103U	AU5/G	G1/4	1/4 NPT	0,669	17	0,31	0,28	0,87
2105105U	AU5/G	G3/8	3/8 NPT	0,866	22	0,35	0,37	1,03
2105107U	AU5/G	G1/2	1/2 NPT	0,984	25	0,43	0,37	1,16

## AU5/N - NPT MALE BSP FEMALE ADAPTORS

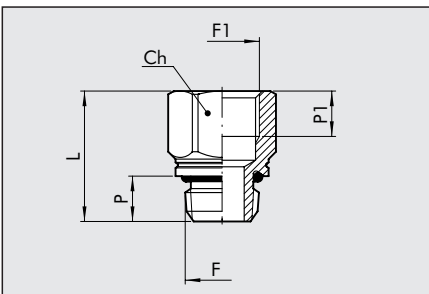

MW Part. No.	Ref.	F	F1	Ch		P	P1	L
				Inc	mm			
2105200U	AU5/N	10/32 UNF	M5	5/16	8	0,16	0,18	0,46
2105201U	AU5/N	1/8 NPT	G1/8	0,551	14	0,24	0,26	0,73
2105203U	AU5/N	1/4 NPT	G1/4	0,669	17	0,31	0,31	0,91
2105205U	AU5/N	3/8 NPT	G3/8	0,866	22	0,35	0,39	1,05
2105207U	AU5/N	1/2 NPT	G1/2	0,984	25	0,43	0,43	1,23

## AU7 - BLANKING PLUGS

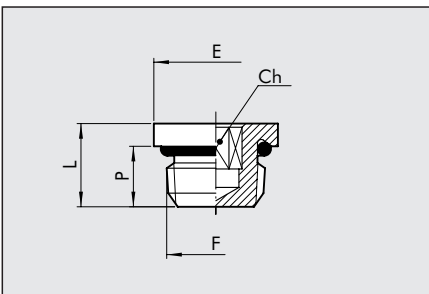

Cod.	Ref.	F	F1	Ch		P	L	E
				Inc	mm			
2107000U	AU7	10/32 UNF	0,079	2	0,16	0,26	0,31	
2107001U	AU7	1/8 NPT	0,118	3	0,24	0,33	0,51	
2107002U	AU7	1/4 NPT	0,236	6	0,31	0,43	0,65	
2107003U	AU7	3/8 NPT	5/16	8	0,35	0,49	0,79	
2107004U	AU7	1/2 NPT	0,394	10	0,43	0,57	0,96	

## IDENTIFICATION MARK FOR AU5

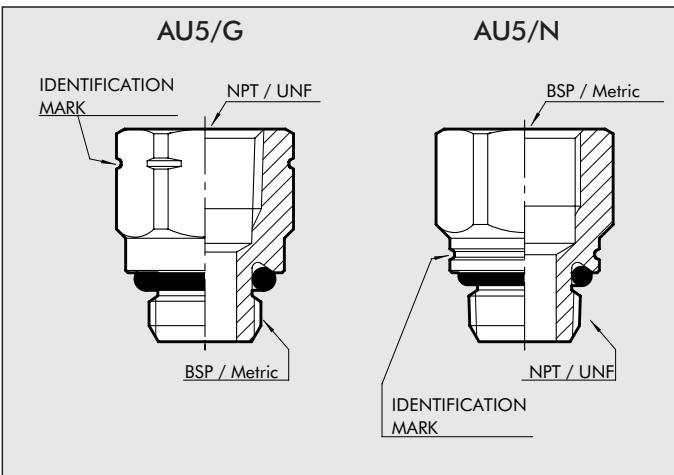

An identification mark near the NPT thread is used to distinguish it from the BSP thread.

